

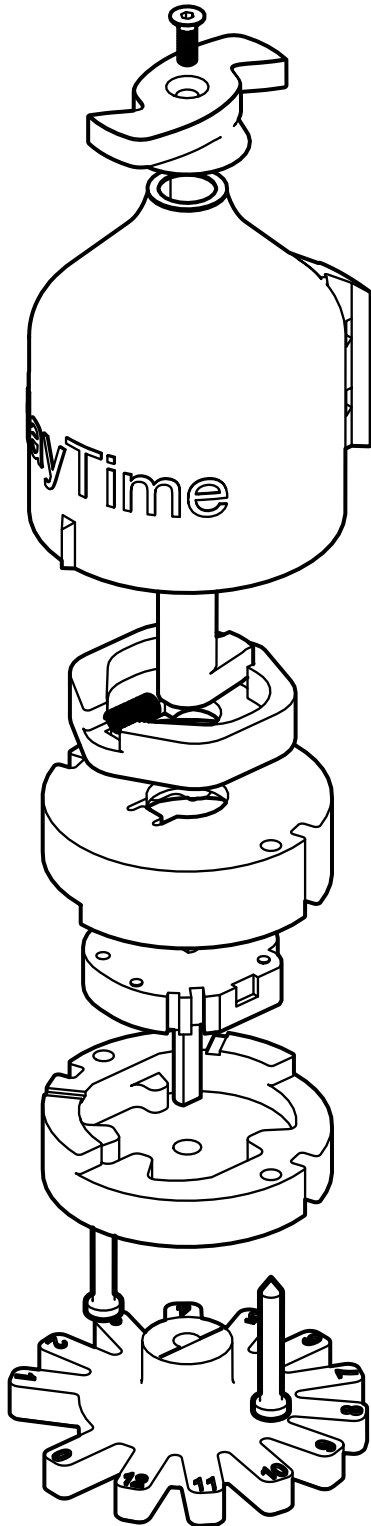

HAYTIME MECHANICAL ASSEMBLY AND DISASSEMBLY INSTRUCTIONS



HayTime timer can be disassembled and its parts replaced using these instructions. All timer parts are available for purchase at the online store (www.haytime.fi).

Please contact us via email (info@haytime.fi) if your timer breaks and you are unsure which part to purchase and replace.

We are happy to assist with any issues related to the timer and its maintenance.

Tools needed for disassembly and assembly of the HayTime timer:

- Torx T20 screwdriver
- Tweezers

List of Timer Parts

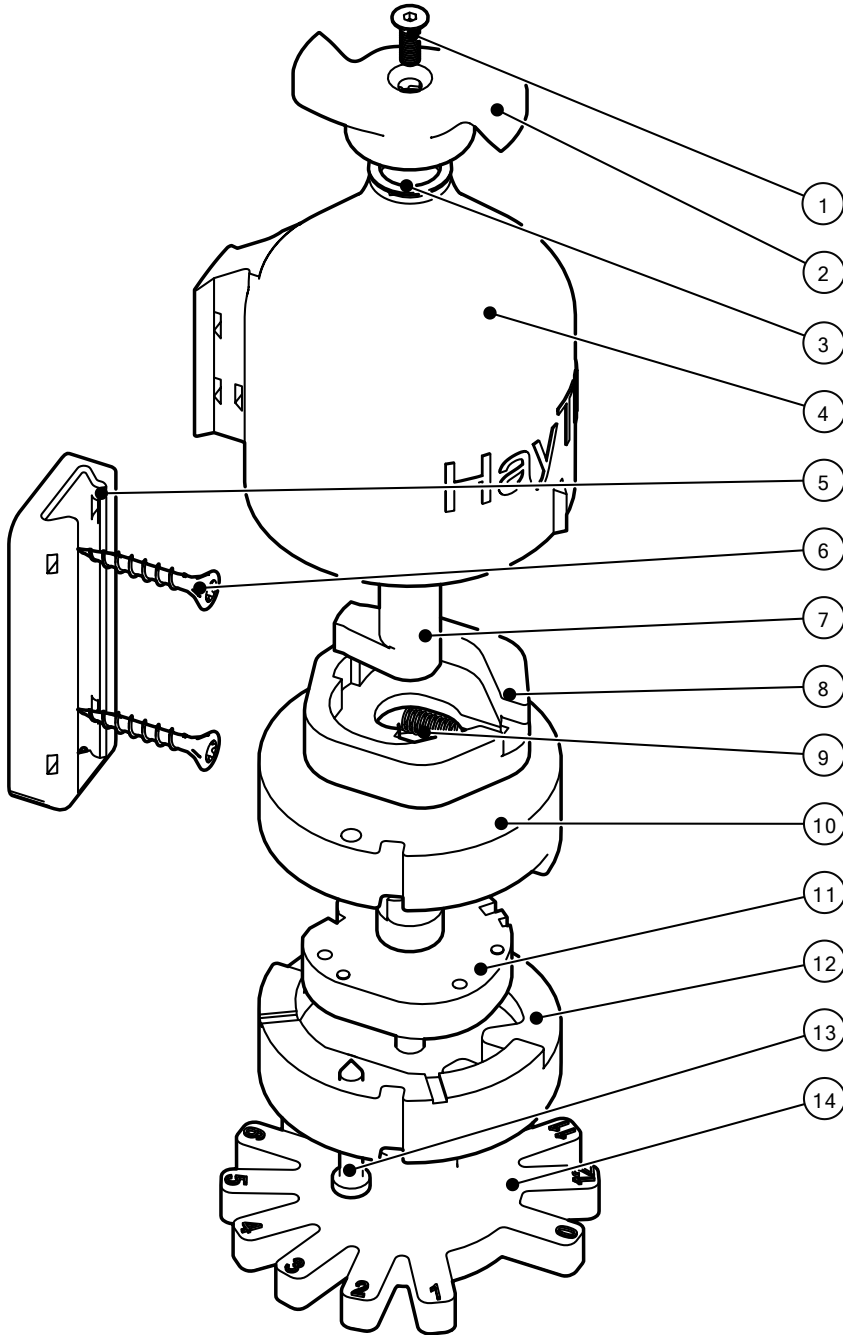

| Number | Name |
|--------|-----------------------|
| 1 | Screw M4x12 |
| 2 | Handle Holder |
| 3 | Gasket |
| 4 | Chassis |
| 5 | Mounting Rail |
| 6 | Stainless steel screw |
| 7 | Release Rotator |
| 8 | Release Mechanism |
| 9 | Spring |
| 10 | Top Inner Chassis |
| 11 | Timer Mechanism 12h |
| 12 | Bottom Inner Chassis |
| 13 | Screw 4x40 Torx20 |
| 14 | Timing Handle 12h |

Disassembly of the Timer

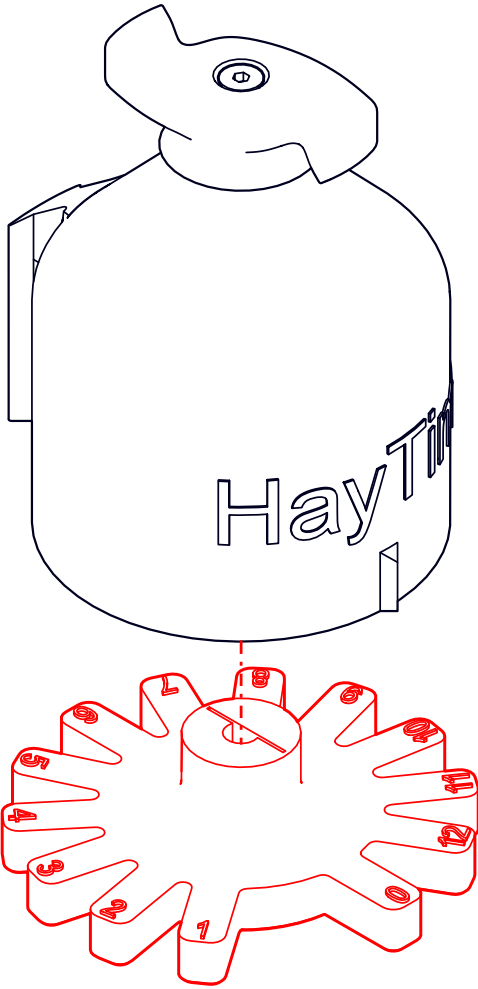

Remove the timer handle by pulling it from the bottom of the timer. The handle may get tightly stuck over time.

You can facilitate removal by levering the handle from the middle of the timer axle with a screwdriver.

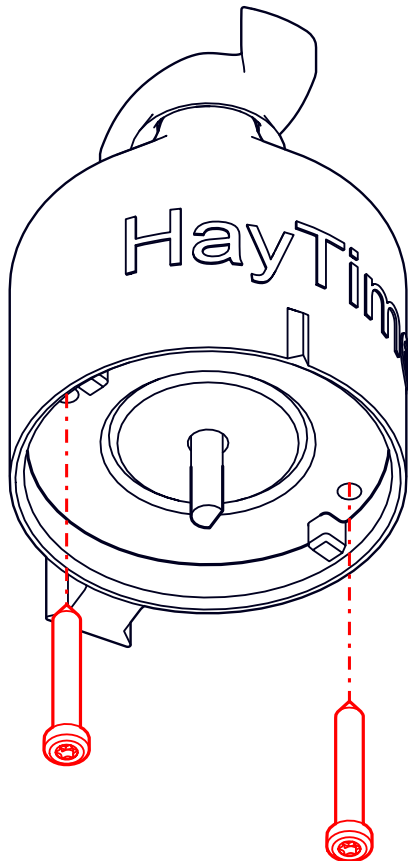
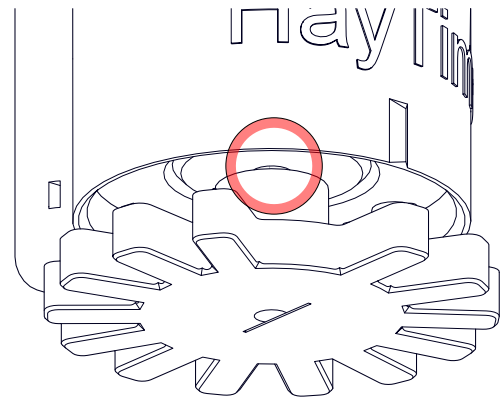

Unscrew two screws from the bottom of the timer using a Torx 20 bit.

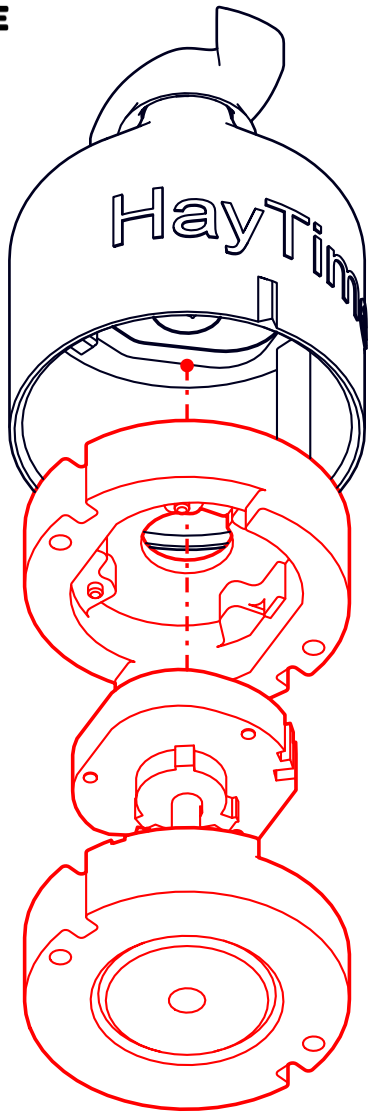

Remove the inner frame parts from the timer frame by pulling the axle (metal shaft) of the timer mechanism.

If you are not replacing the timer mechanism, there is no need to remove it from the upper inner frame. **However, the timer mechanism must be wound before reinstallation into the frame.**

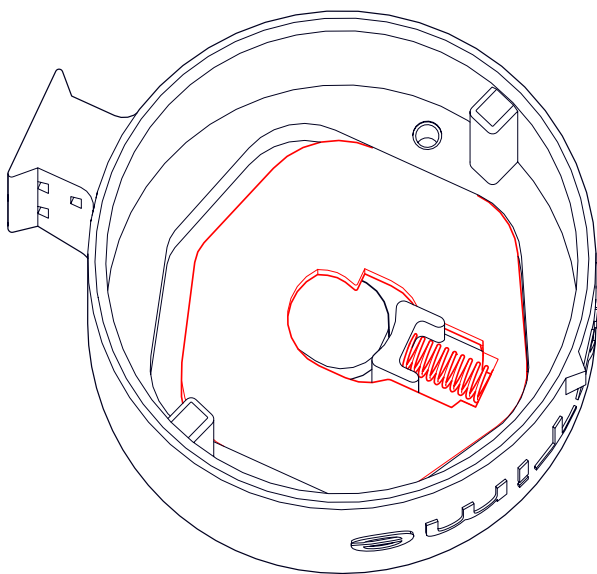

Remove the spring and release mechanism. The spring is easiest to remove with tweezers.

You can also remove the spring and release mechanism by placing the timer upright on a table and tapping the top of the timer.

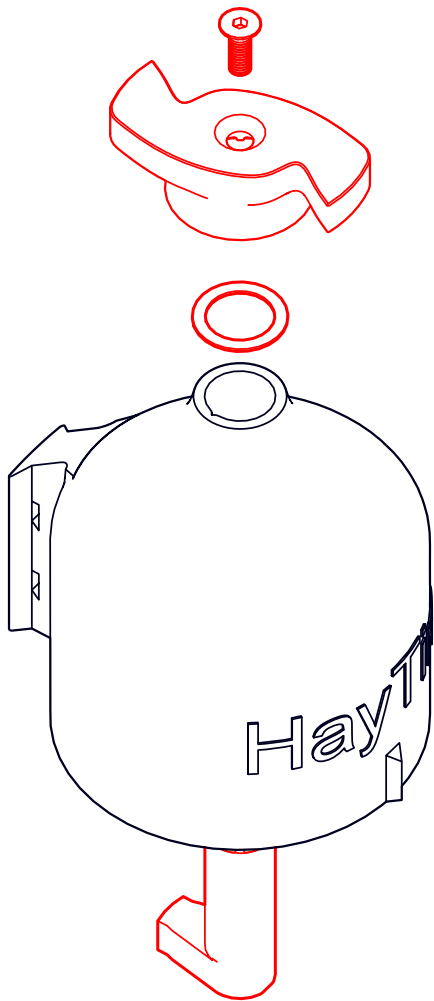

Remove the handle holder, release pin, and gasket by unscrewing the screw in the handle holder. The gasket is greased.

The screw head is Torx 20.

The handle holder may still be tightly attached even after unscrewing. Remove it by pulling it straight up.

Assembly of the Timer

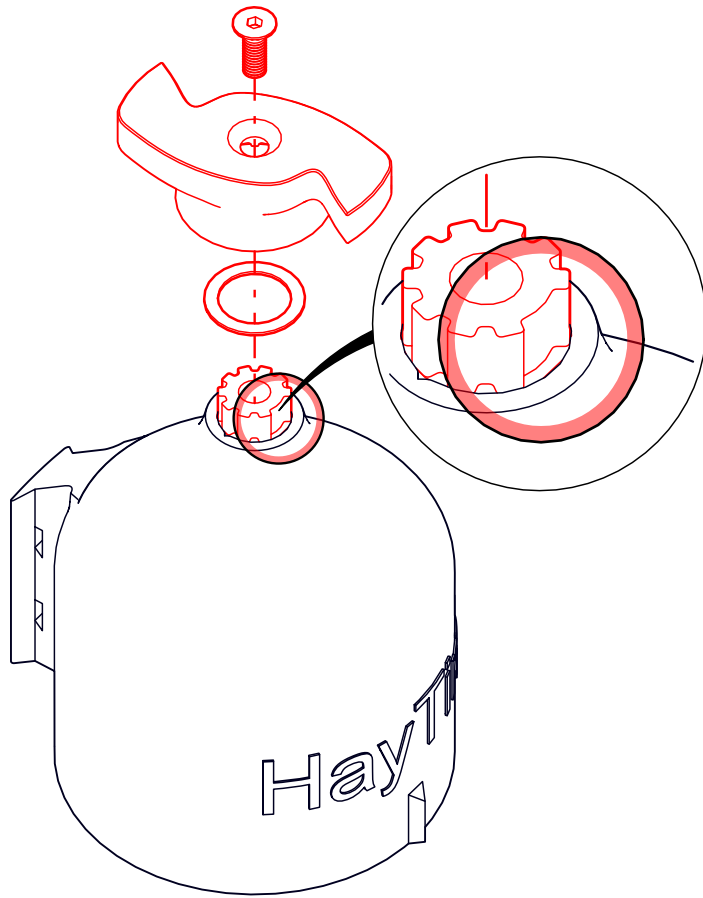

Assemble the release pin, gasket, and handle holder with the screw.

The release pin and handle holder have a shape that ensures they are assembled correctly relative to each other. When assembling, align the shapes of the release pin and handle holder.

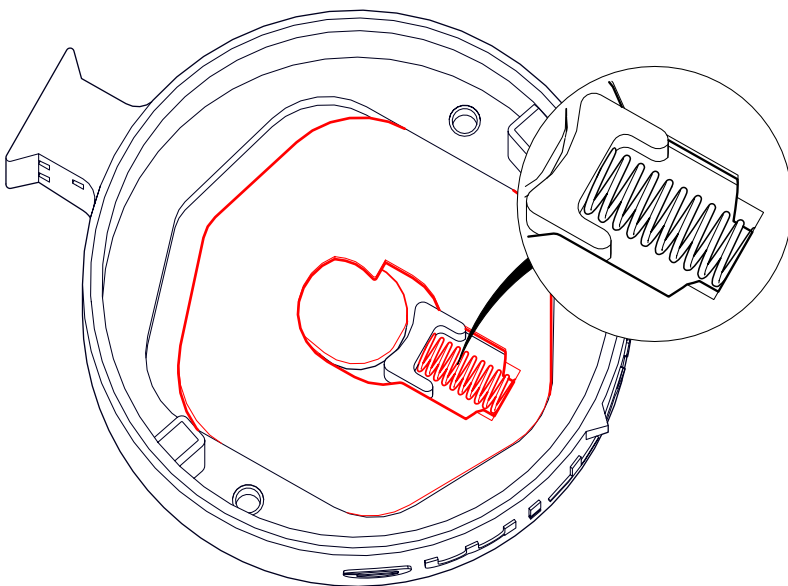

Place the release mechanism in place. Then install the spring. It is recommended to use tweezers for installing the spring.

You can test the mechanism by turning the handle holder and checking how the mechanism locks.

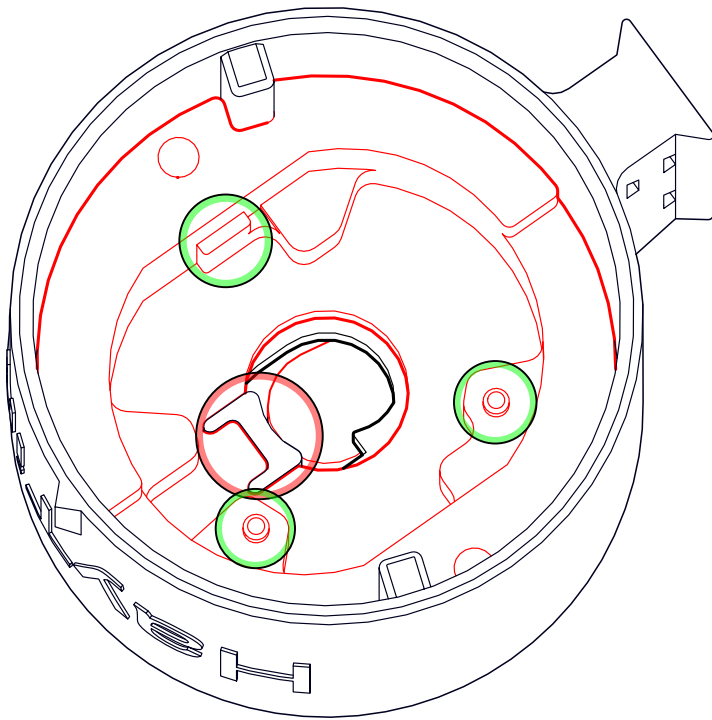

Install the upper inner chassis into the frame. Ensure that the shapes of the frame and upper inner chassis match (circled in red in the picture).

Then install the timer mechanism. The timer mechanism fits into the areas circled in green in the picture.

Before placing the timer mechanism in position, wind the timer mechanism by rotating the timer axle (long metal shaft), otherwise, installation will not succeed. You can use the timer handle as an aid. Finally, ensure that the timer mechanism is pressed through the green-circled pins.

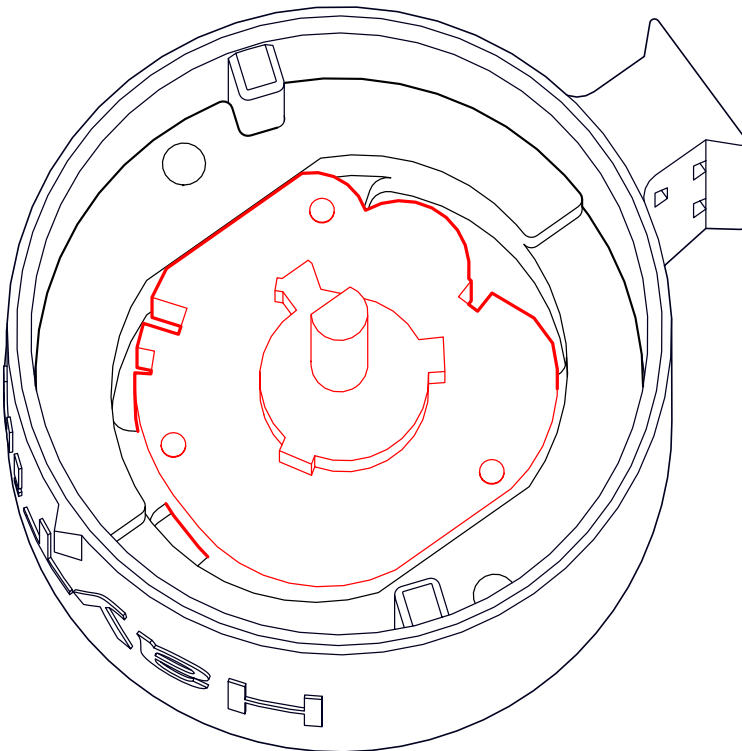

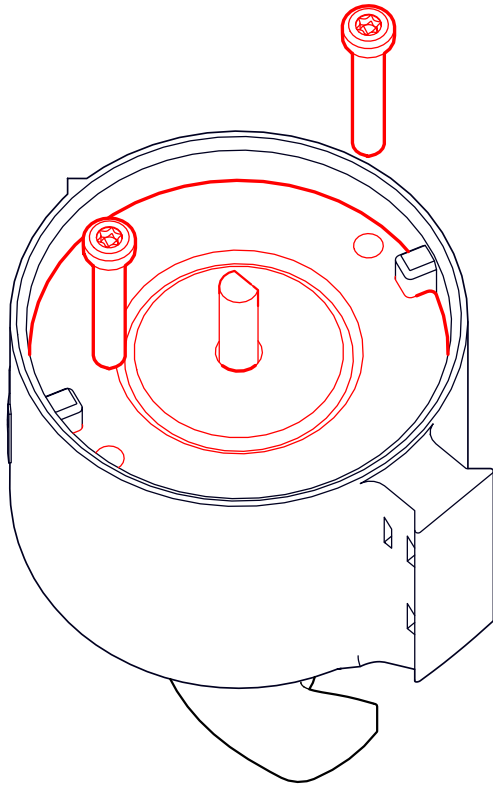

Install the lower inner chassis and secure it with two screws. Ensure that the lower inner frame goes into the frame correctly (otherwise, you won't be able to screw in the screws).

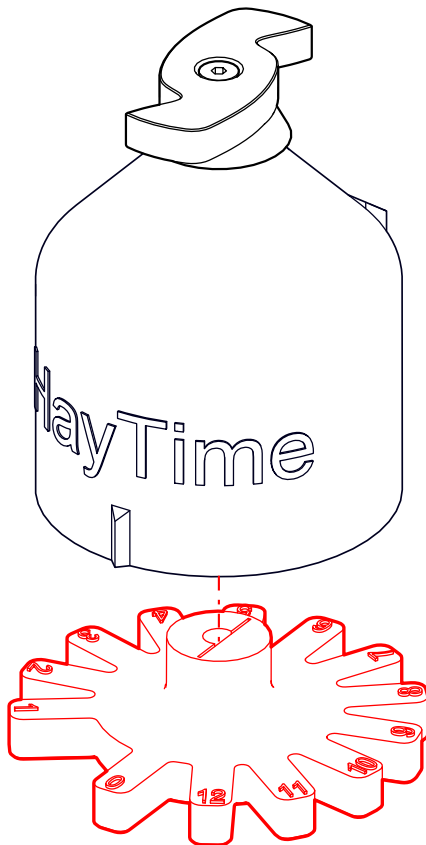

Push the timer handle into place.

Assembly is complete!